

COUNCIL REPORT

TO: CITY MANAGER **DATE:** 2018 January 17

FROM: DIRECTOR PLANNING AND BUILDING **FILE:** 87000 05
Reference: **ROD #17-05**

SUBJECT: **ROAD CLOSURE REFERENCE #17-05**
X-REFERENCES: SUBDIVISION #17-27; REZONING #16-22
Proposed Closure of a Portion of Lane between 7550 Rosewood Street and 7210 Mary Avenue

PURPOSE: To obtain Council authority to introduce a Burnaby Highway Closure Bylaw for the closure of a portion of lane between 7550 Rosewood Street and 7210 Mary Avenue.

RECOMMENDATION:

1. **THAT** Council authorize the introduction of Burnaby Highway Closure Bylaw for a 91 m² (979.52 sq.ft.) portion of unopened lane allowance, as shown on the *attached* Sketch #1.

REPORT

On 2017 October 02, Council granted Second Reading of the rezoning bylaw for Rezoning Reference #16-22, which proposes development of a new seniors long-term care facility and guidelines for a future seniors mid-rise apartment building on a site encompassing 7126, 7210, and 7216 Mary Avenue, a small portion of 7550 Rosewood Street, and a portion of unopened lane allowance between 7550 Rosewood Street and 7210 Mary Avenue that is not required for City purposes (see Sketch #1 *attached*). A Highway Closure Bylaw is required to close the unopened lane allowance.

The proposed lane closure area is 91 m² (979.52 sq.ft.). As the lane closure area is less than required road dedications, payment of compensation to the City is not required.

It is recommended that Council authorize the introduction of a Burnaby Highway Closure Bylaw, which appears elsewhere on this Council agenda. With subsequent adoption of the bylaw, the subject lane area would be closed, consolidated with the rezoning site, and reconfigured as part of the completion of the applicable subdivision and road closure applications.

Lou Pelletier, Director
PLANNING AND BUILDING

KH:eb

Attachmentcc: Director Engineering
City SolicitorDirector Public Safety and Community Services
City Clerk

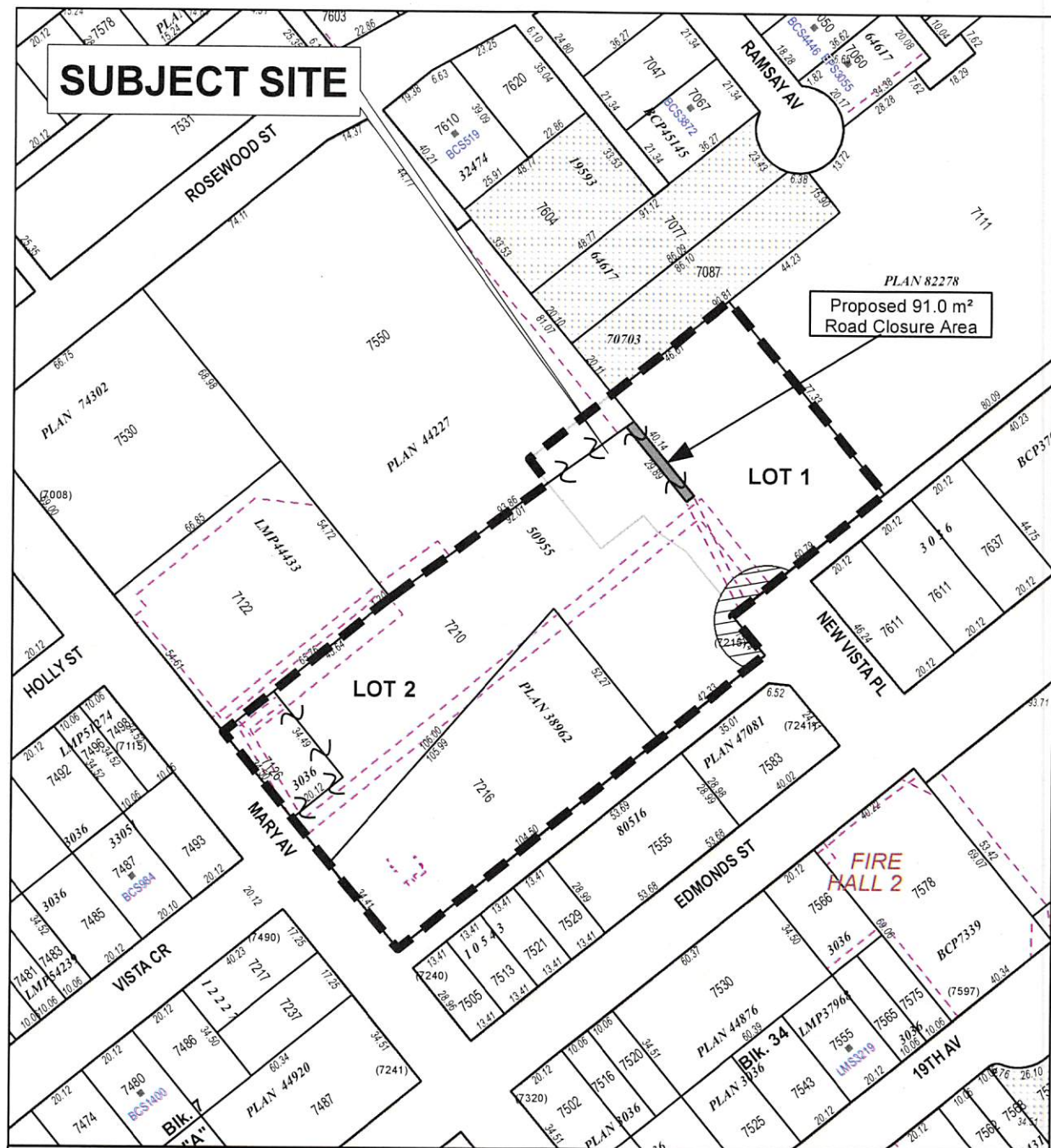

PLANNING & BUILDING DEPARTMENT

DATE:
SEP 27 2017

SCALE:
1:2,000

DRAWN BY:
AY

SUBDIVISION REFERENCE #17-27
REZONING REFERENCE #16-22
ROAD CLOSURE REFERENCE #17-05
7126, 7210 AND 7216 MARY AVENUE
PORTION OF 7550 ROSEWOOD STREET



Subject Site



Proposed Road Dedication

Sketch #1