

CITY OF BURNABY

BYLAW NO. 13971

A BYLAW to amend Bylaw No. 4742, being
Burnaby Zoning Bylaw 1965

WHEREAS application for rezoning has been made to the Council;

AND WHEREAS the Council has held a public hearing thereon after duly giving notice of the hearing as prescribed by sections 466 and 467 of the *Local Government Act*, R.S.B.C. 2015;

NOW THEREFORE the Council of the City of Burnaby ENACTS as follows:

1. This Bylaw may be cited as **BURNABY ZONING BYLAW 1965, AMENDMENT BYLAW NO. 47, 2018.**
2. The Map (hereinafter called "Map 'A'") attached to and forming an integral part of Bylaw No. 4742, being Burnaby Zoning Bylaw 1965, and designated as the Official Zoning Map of the City of Burnaby, is hereby amended according to the Maps (hereinafter collectively called "Map 'B'"), marginally numbered REZ. 4159 annexed to this Bylaw, and in accordance with the explanatory legend, notations, references and boundaries designated, described, delimited and specified in particularity shown upon said Map 'B', and the various boundaries and districts shown upon said Map 'B', respectively are an amendment of and in substitution for the respective districts, designated and marked on said Map 'A' insofar as the same are changed, modified or varied thereby,

and the said Map 'A' shall be deemed to be and is hereby declared to be amended accordingly and the said Map 'B' is hereby declared to be and shall form an integral part of said Map 'A' as if originally incorporated therein and shall be interpreted accordingly.

Read a first time this	day of	2018
Read a second time this	day of	2019
Read a third time this	day of	2019
Reconsidered and adopted by Council this	day of	2019

MAYOR

CLERK

BYLAW NUMBER 13971 BEING A BYLAW TO AMEND BYLAW
NUMBER 4742 BEING BURNABY ZONING BYLAW 1965

REZ.17-10017

LEGAL: Lots' 13, 14, 15 Except: Part Dedicated Road On Plan 36222; District Lot 80, Group1, New Westminster District
Plan 10063

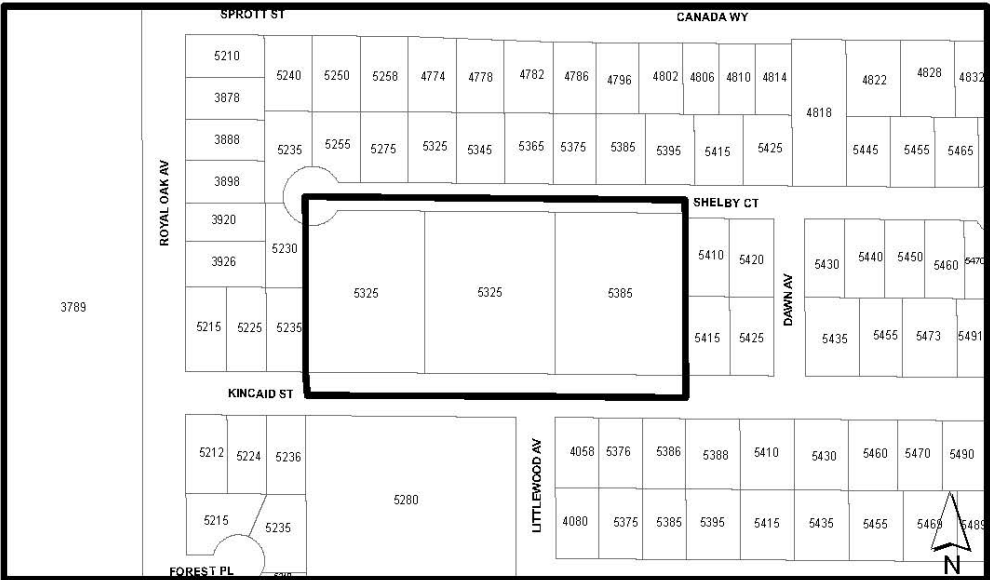

THE AREA(S) SHOWN ABOVE OUTLINED IN BLACK (—) IS (ARE) REZONED

FROM: P2 Administration and Assembly District

TO: R2 Residential District

	PLANNING AND BUILDING DEPARTMENT	
	OFFICIAL ZONING MAP	
Date: DEC 04 2018	Map "B" No. REZ. 4159	
scale: 1:2,550		
Drawn By: AY		