

THIS IS A GLOBAL PROVINCIAL CONCERN

New Housing project

Date: February20/2019

Author: Lembe Henri

Title: Student at ELS program

Lembe Henri
[REDACTED]
Surrey, BC
Phone: [REDACTED]

Top View of parking spot & licensed trucks-trailers

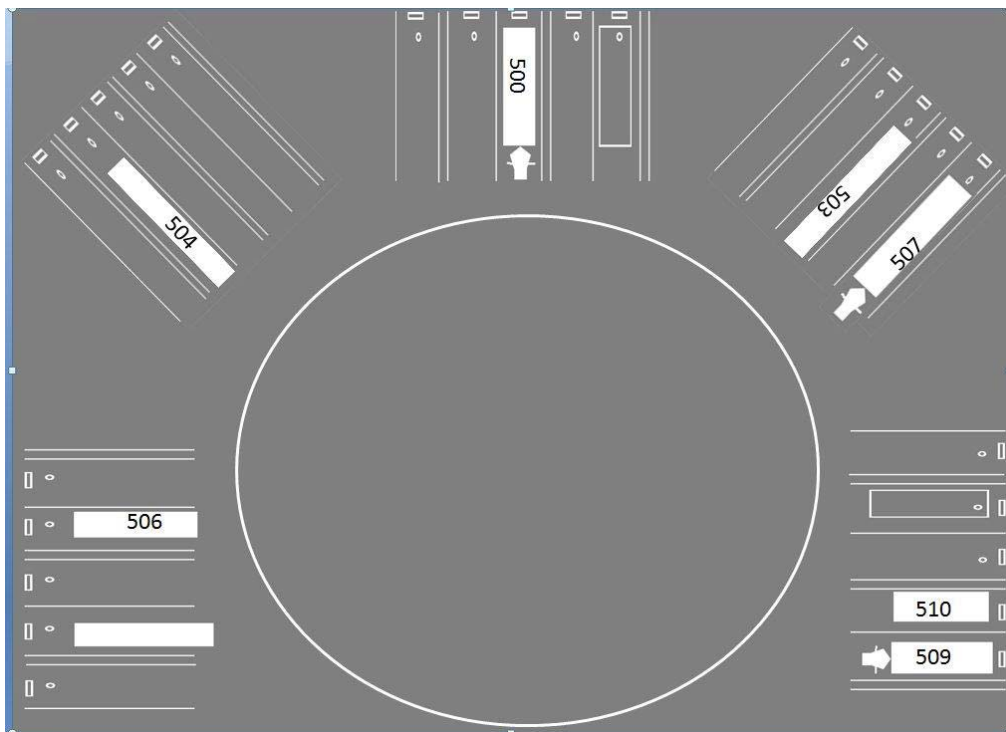

Each trailer has a separate power supply of hot & water. Also vehicle plate of each trailers, should matched with the truck or a pickup of residents.

Referred to:

Environment and Social Planning Committee (2019.04.02)

Copied to:

City Manager

Dir. Corporate Services

Dir. Planning and Building

Dir. Engineering

Underground view of trailers at the left sid

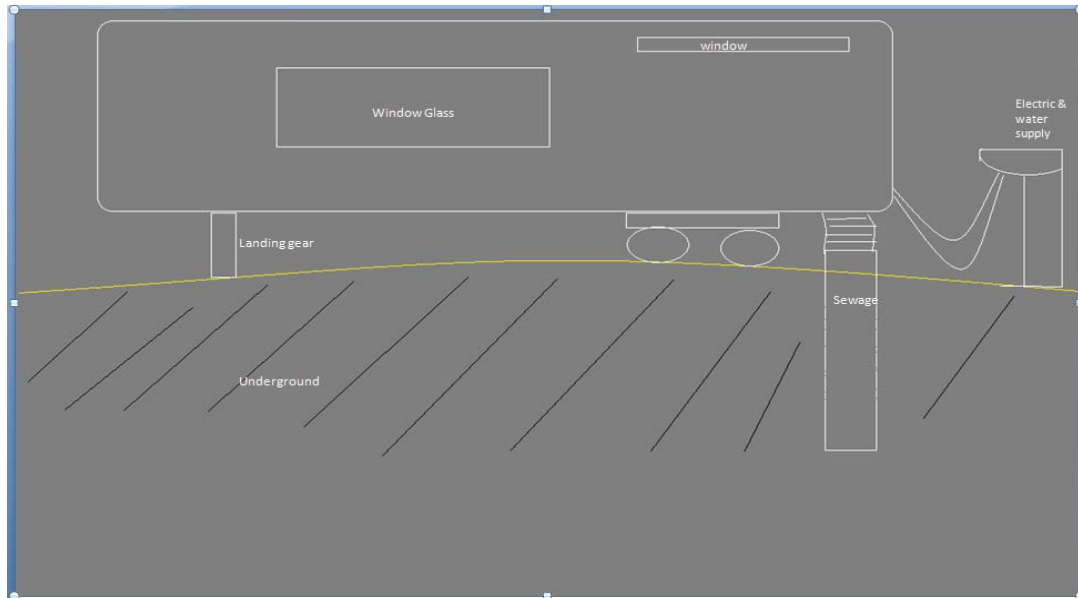

Sewage should be covered permanently if any trailer is available on parking spot. The supplier of resources can be modified for many purposes.

Top view of trailer & inner architecture

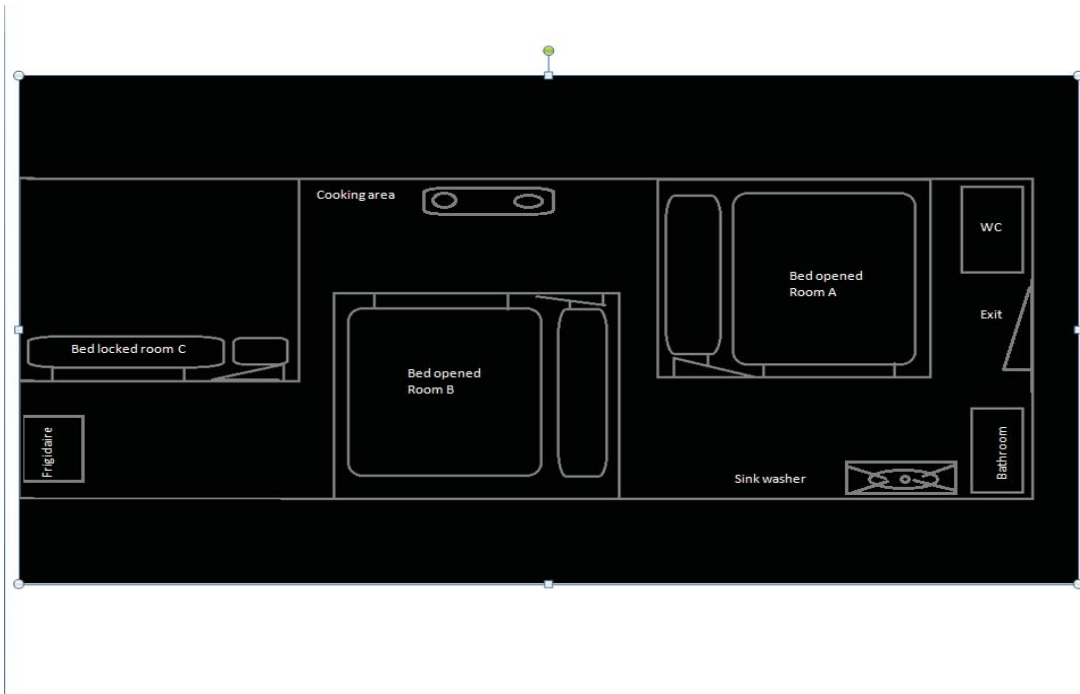

The inner compartment should have a vacuum air which will be facing outside to the left and right side of container and the sizes has to meet the requirements of the Motor vehicle Act Regulation.

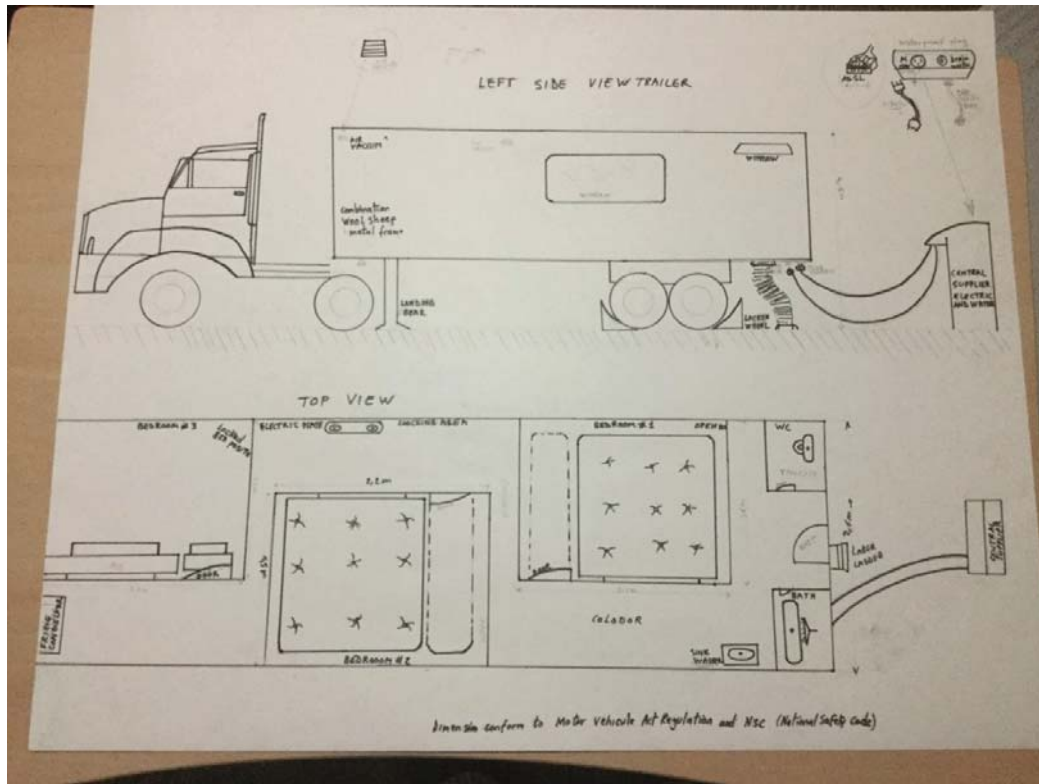

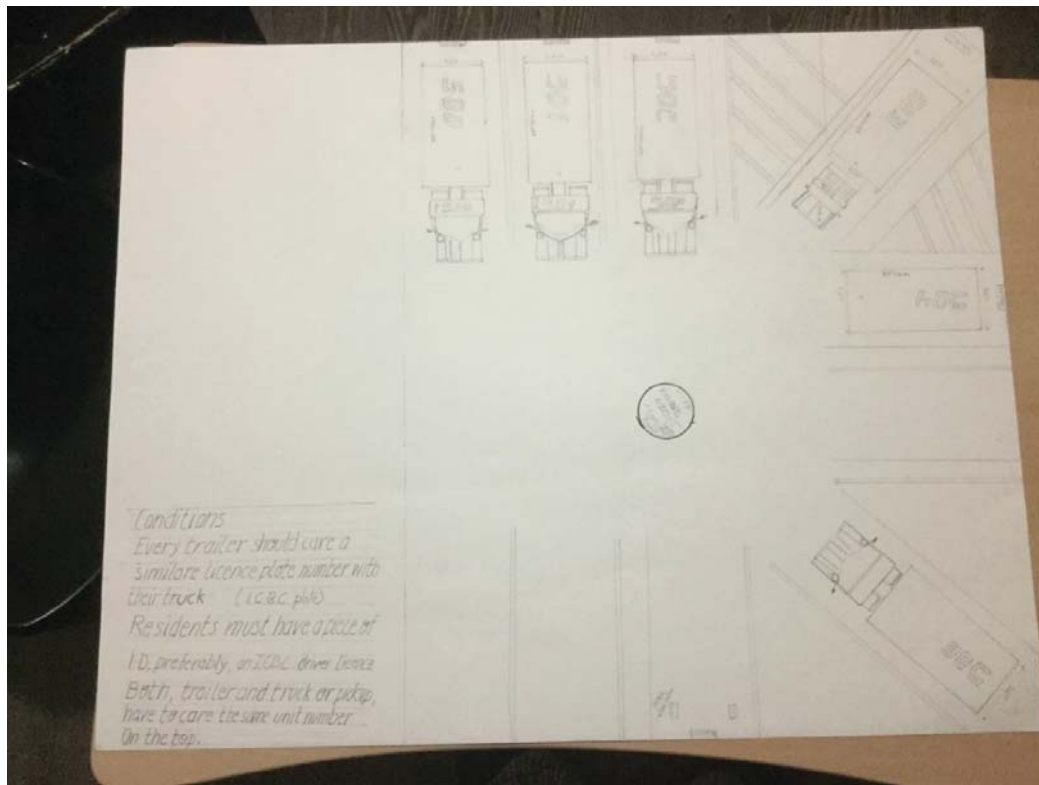

Advantages & disadvantages

The only challenging of this project is that requires electric et water line to be extend far in many kilometer as well to amplifier their intensity on service.

Beside the disadvantages, that project is economically less cost on budget and faster than skyscraper to be builds. Also this may reduce considerably homeless issues and poverty in BC. Finally, the current project build in different siite or aboard HWY could be, transform easily to another plan in the future without any cost of money and human means.