

CITY OF BURNABY

BYLAW NO. 14039

A BYLAW to amend Bylaw No. 4742, being Burnaby Zoning

Bylaw 1965, as amended by Bylaw Nos. 7496, 10267, and 10684
being Burnaby Zoning Bylaw 1965, Amendment Bylaw Nos. 14,
1980, 38, 1995, and 66, 1997

WHEREAS application for rezoning has been made to the Council;

AND WHEREAS the Council has held a public hearing thereon after duly giving
notice of the time and place of such hearing as prescribed by Sections 466 and 467 of the *Local
Government Act*, R.S.B.C. 2015;

NOW THEREFORE the Council of the City of Burnaby ENACTS as follows:

1. This Bylaw may be cited as **BURNABY ZONING BYLAW 1965, AMENDMENT
BYLAW NO. 20, 2019.**

2. Bylaw No. 4742, as amended by Bylaw Nos. 7496, 10267 and 10684, is further
amended as follows:

(a) The Map (hereinafter called "Map 'A'"), attached to and forming an integral part of
Bylaw No. 4742, being "Burnaby Zoning Bylaw 1965", and designated as the Official Zoning Map of
the City of Burnaby, is hereby amended according to the Map (hereinafter called "Map 'B'"),
marginally numbered R.Z. 4178, annexed to this Bylaw, and in accordance with the explanatory
legend, notations, references and boundaries designated, described, delimited and specified in
particularity shown upon said Map 'B'; and the various boundaries and districts shown upon said

Map 'B' respectively are an amendment of and in addition to the respective districts, designated and marked on said Map 'A' insofar as the same are changed, modified or varied thereby, and the said Map 'A' shall be deemed to be and is hereby declared to be amended accordingly and the said Map 'B' is hereby declared to be and shall form an integral part of said Map 'A', as if originally incorporated therein and shall be interpreted accordingly.

(b) The Comprehensive Development Plans more particularly described in Bylaw Nos. 7496, 10267, and 10684 are amended in accordance with the adopted Development Plan entitled “3555 Gilmore Way, Burnaby” prepared by Gustavson Wylie Architects Inc. and on file in the office of the Director Planning and Building; and any development on the lands rezoned by this Bylaw shall be in conformity with the said Comprehensive Development Plans as amended.

Read a first time this	day of	2019
Read a second time this	day of	2019
Read a third time	day of	2019
Reconsidered and adopted this	day of	2019

MAYOR

CLERK

BYLAW NUMBER 14039 BEING A BYLAW TO AMEND BYLAW
NUMBER 4742 BEING BURNABY ZONING BYLAW 1965

REZ.11-46

LEGAL: Lot A, DL 71, Group 1, NWD Plan LMP24640

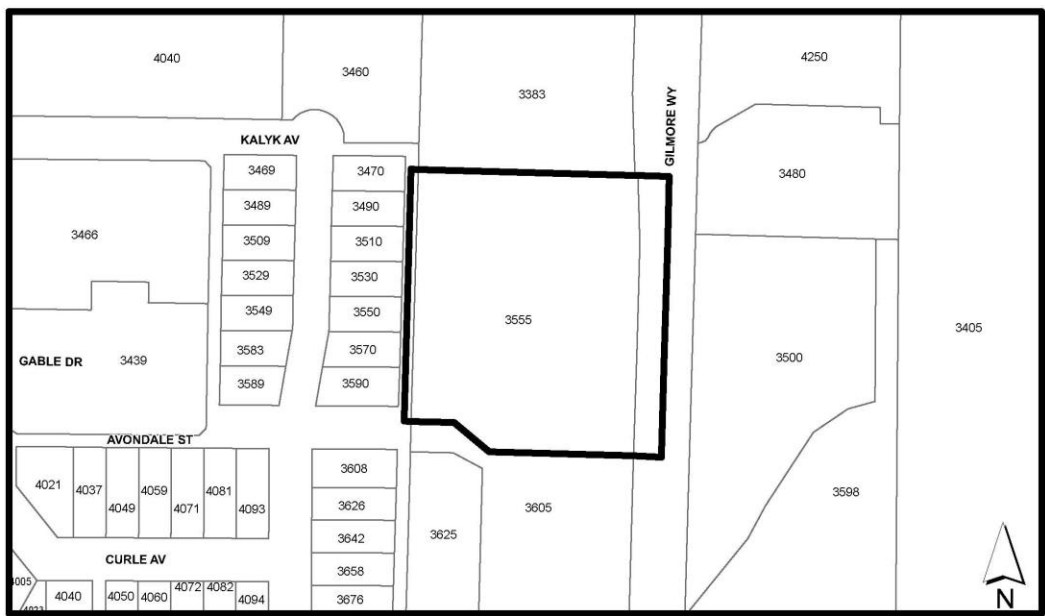

THE AREA(S) SHOWN ABOVE OUTLINED IN BLACK (——) IS (ARE) REZONED

FROM: CD Comprehensive Development District (based on M8 Advanced Technology Research District)

TO: Amended CD Comprehensive Development District (based on M8 Advanced Technology Research District, and Discovery Place Community Plan guidelines and in accordance with the development plan entitled "3555 Gilmore Way, Burnaby B.C." prepared by Gustavson Wylie Architects Inc.)

	PLANNING AND BUILDING DEPARTMENT	
Date: JUN 25 2019	OFFICIAL ZONING MAP	Map "B" No. REZ. 4178
scale: 1:2,700		
Drawn By: AY		