

**CITY OF BURNABY**

**BYLAW NO. 14203**

A BYLAW to amend Bylaw No. 4742, being Burnaby Zoning Bylaw 1965, as amended by Bylaw Nos. 7496, 7568, 9835, 10267, and 11388 being Burnaby Zoning Bylaw 1965, Amendment Bylaw Nos. 14, 1980, 44, 1980, 3, 1993, 38, 1995, and 18, 2002

WHEREAS application for rezoning has been made to the Council;

AND WHEREAS the Council has held a public hearing thereon after duly giving notice of the time and place of such hearing as prescribed by Sections 466 and 467 of the *Local Government Act*, R.S.B.C. 1996;

NOW THEREFORE the Council of the City of Burnaby ENACTS as follows:

1. This Bylaw may be cited as **BURNABY ZONING BYLAW 1965, AMENDMENT BYLAW NO. 30, 2020.**

2. Bylaw No. 4742, as amended by Bylaw Nos. 7496, 7568, 9835, 10267, and 11388, is further amended as follows:

(a) The Map (hereinafter called "Map 'A'"), attached to and forming an integral part of Bylaw No. 4742, being "Burnaby Zoning Bylaw 1965", and designated as the Official Zoning Map of the City of Burnaby, is hereby amended according to the Map (hereinafter called "Map 'B'"), marginally numbered REZ. 4233, annexed to this Bylaw, and in accordance with the explanatory legend, notations, references and boundaries designated, described, delimited and specified in particularity shown upon said Map 'B'; and the various boundaries and districts shown upon said Map 'B' respectively are an amendment of and in addition to the respective districts, designated and marked on said Map 'A' insofar as the same are changed, modified or varied thereby, and the said Map 'A' shall be deemed to be and is hereby declared to be amended

accordingly and the said Map 'B' is hereby declared to be and shall form an integral part of said Map 'A', as if originally incorporated therein and shall be interpreted accordingly.

(b) The Comprehensive Development Plans, more particularly described in Bylaw Nos. 7496, 7568, 9835, 10267, and 11388 are amended as may be necessary by the development plan entitled "3700 Gilmore At Sanderson Way, Burnaby, BC" prepared by Turner/Dialog and on file in the office of the Director Planning and Building, and any development on the lands rezoned by this Bylaw shall be in conformity with the said Comprehensive Development Plans as amended.

Read a first time this	day of	, 2020
Read a second time this	day of	, 2020
Read a third time this	day of	, 2020
Reconsidered and adopted by Council this	day of	, 2020

MAYOR

CLERK

BYLAW NUMBER 14203 BEING A BYLAW TO AMEND BYLAW  
NUMBER 4742 BEING BURNABY ZONING BYLAW 1965

**REZ.19-52**

LEGAL: Lot A, District Lots 71 and 72, Group 1, NWD Plan LMP 39888

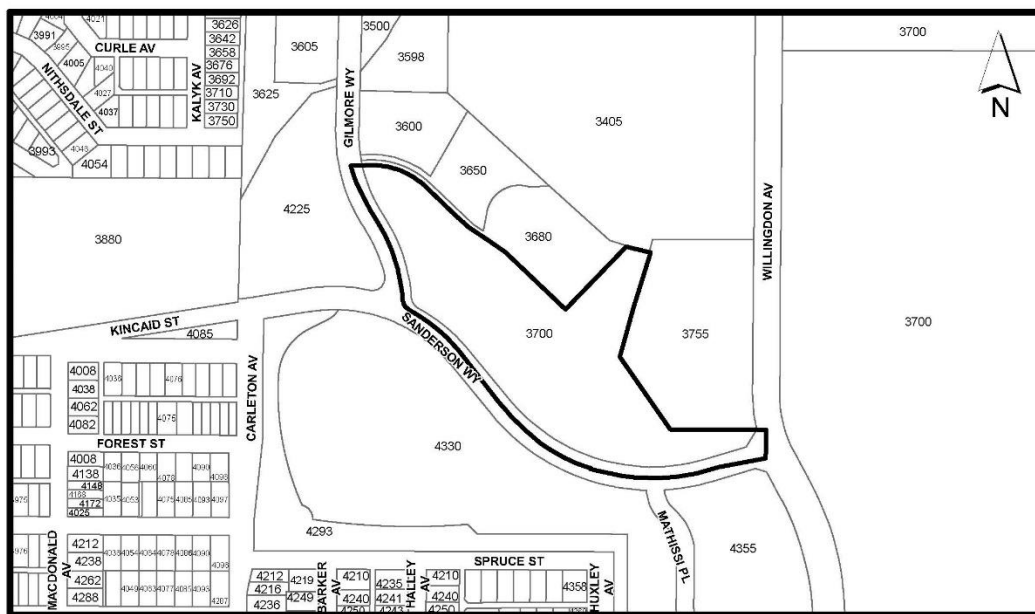

THE AREA(S) SHOWN ABOVE OUTLINED IN BLACK (——) IS (ARE) REZONED

FROM: CD Comprehensive Development District (based on the M5 Light Industrial District and M8 Advanced Technology Research District)

TO: Amended CD Comprehensive Development District (based on the M5 Light Industrial District and M8 Advanced Technology Research District, the Discovery Place Community Plan as guidelines, and in accordance with the development plan entitled "3700 Gilmore At Sanderson Way, Burnaby, BC" prepared by Turner/Dialog)

	PLANNING AND BUILDING DEPARTMENT	
Date: JUL 22 2020	<b>OFFICIAL ZONING MAP</b>	
Scale: 1:6,500		
Drawn By: RW		
		Map "B" No. REZ. 4233