

CITY OF BURNABY

BYLAW NO. 14400

A BYLAW to amend Bylaw No. 4742, being Burnaby Zoning Bylaw 1965, as amended by Bylaw No. 6852 being Burnaby Zoning Bylaw 1965, Amendment Bylaw No. 24, 1976

WHEREAS application for rezoning has been made to the Council;

AND WHEREAS the Council has held a public hearing thereon after duly giving notice of the time and place of such hearing as prescribed by Sections 466 and 467 of the *Local Government Act*, R.S.B.C. 2015, c.1;

NOW THEREFORE the Council of the City of Burnaby ENACTS as follows:

1. This Bylaw may be cited as **BURNABY ZONING BYLAW 1965, AMENDMENT BYLAW NO. 35, 2021.**

2. Bylaw No. 4742, as amended by Bylaw No. 6852, is further amended as follows:

(a) The Map (hereinafter called "Map 'A'"), attached to and forming an integral part of Bylaw No. 4742, being "Burnaby Zoning Bylaw 1965", and designated as the Official Zoning Map of the City of Burnaby, is hereby amended according to the Map (hereinafter called "Map 'B'"), marginally numbered REZ. 4390, annexed to this Bylaw, and in accordance with the explanatory legend, notations, references and boundaries designated, described, delimited and specified in particularity shown upon said Map 'B'; and the various boundaries and districts shown upon said Map 'B' respectively are an amendment of and in addition to the respective districts, designated and marked on said Map 'A' insofar as the same are changed, modified or varied thereby, and the said Map 'A' shall be deemed to be and is hereby declared to be amended accordingly and the said Map 'B' is hereby declared to be and shall form an integral part of said

BYLAW NUMBER 14400 BEING A BYLAW TO AMEND BYLAW
NUMBER 4742 BEING BURNABY ZONING BYLAW 1965

REZ.21-17

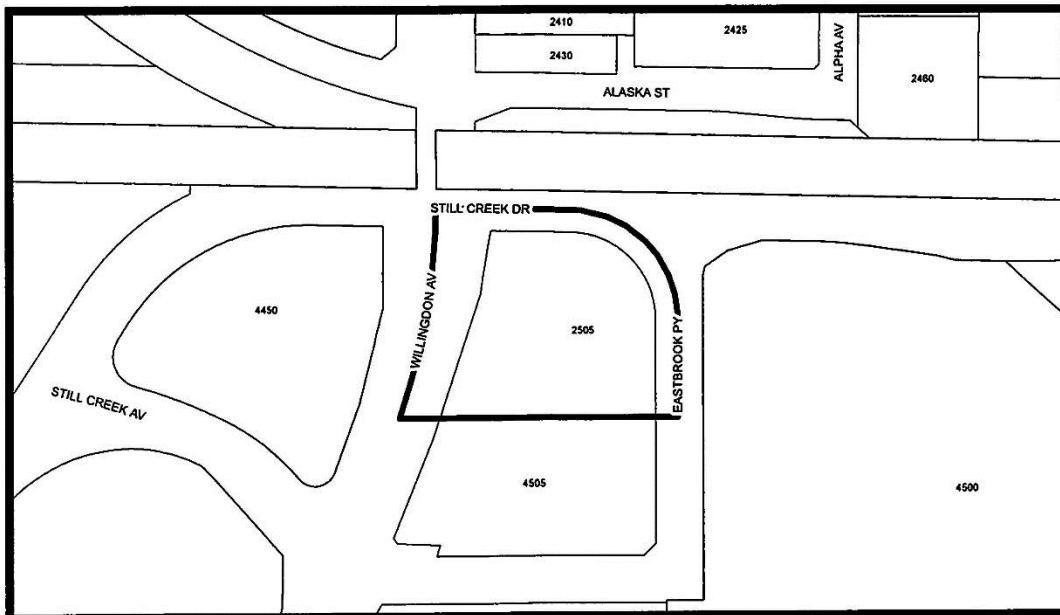

LEGAL: Lot 127 District Lot 124 Group 1 New Westminster District Plan 51872



THE AREA(S) SHOWN ABOVE OUTLINED IN BLACK (——) IS (ARE) REZONED

FROM: CD Comprehensive Development District (based on M5 Light Industrial District as a guideline)

TO: CD Comprehensive Development District (based on the M5 Light Industrial District and M1 Manufacturing District as guidelines, and in accordance with the development plan entitled "Tesla Service Centre" prepared by T.I. Studios Architecture Inc.)

		PLANNING & BUILDING DEPARTMENT			
Date:	NOV 08 2021	OFFICIAL ZONING MAP		Map "B"	4390
Scale:	1:3,000			No. REZ.	
Drawn By:	RW				