

BRIDGE SITE IS LOCATE AT THE MOUTH OF DEER LAKE BROOK APPROXIMATELY 100 METRES DOWNSTREAM S.W. OF DEER LAKE AVENUE

KEY PLAN  
SCALE: N.T.S.

- SURVEY LEGEND:**
- MV DENOTES WATER VALVE
  - DENOTES CATCH BASIN - TOP ENTRY
  - DENOTES POWER POLE
  - DENOTES STREET LIGHT - POST TOP
  - DENOTES GUY WIRE
  - DENOTES MISCELLANEOUS MANHOLE
  - DENOTES TREE AND CANOPY EXTENT
  - DENOTES GROUND ELEVATION

- (tw) DENOTES TOP OF RETAINING WALL ELEVATION
- Dec. DENOTES DECIDUOUS
- Con. DENOTES CONIFEROUS
- Conc. DENOTES CONCRETE
- Rt. DENOTES RETAINING WALL
- /C DENOTES INSPECTION CHAMBER
- DENOTES SIGN

- LEGEND:**
- RECONSTRUCTED GRAVEL PATHWAY
  - AT GRADE TIMBER BOARDWALK
  - NEW BRIDGE STRUCTURE
  - NEW ELEVATED BOARDWALK
  - SHEET PILE
  - BOARDWALK PIER COLUMN
  - BRIDGE PILES
  - APPROXIMATE WATER ELEVATION AT TIME OF SURVEY

**NOTES:**

1. ELEVATION AND STATIONS ARE SHOWN IN METRES WHILE ALL OTHER DIMENSIONS ARE SHOWN IN MILLIMETRES, UNLESS NOTED OTHERWISE.

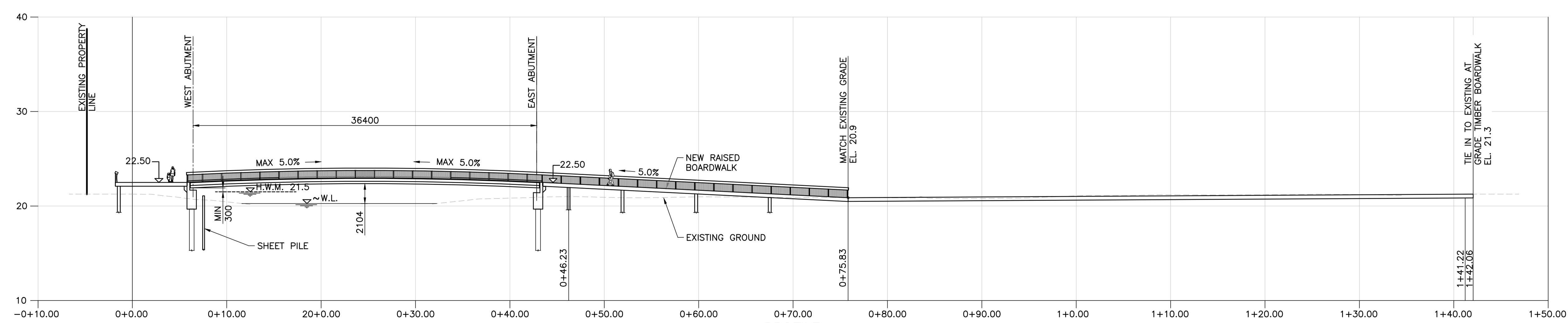

PLOT DATE: February 9, 2024

REV NO	REVISIONS	DATE	DRAWN	APPRD
0	FOR INFORMATION ONLY	2024-02-09	JK	SK



DEER LAKE BROOK PEDESTRIAN BRIDGE  
PLAN AND PROFILE



SCALE		DATE		DWG. NO.
AS SHOWN	2024-02-09	01 of 02		
DRAWN BY	JK	DESIGN BY	SK	
CHECKED BY	SK	APPROVED BY	SAL	
REV. 0				



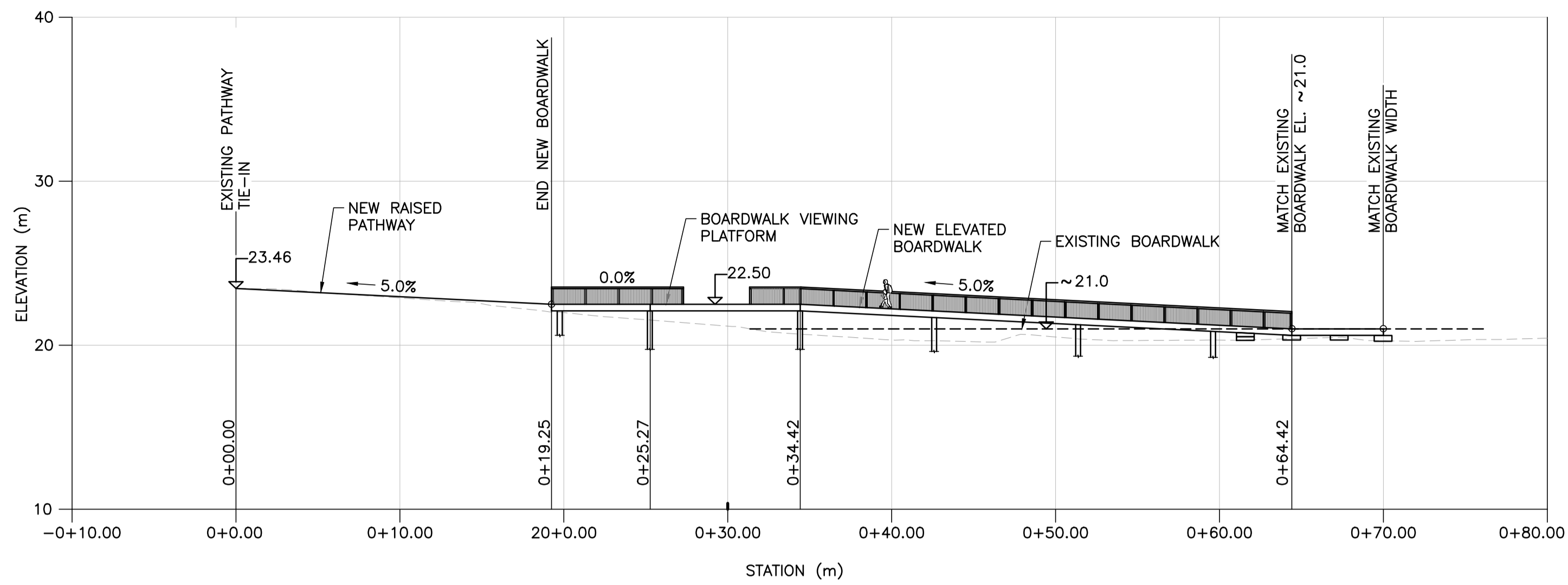

**BOARDWALK PROFILE**  
SCALE 1:250

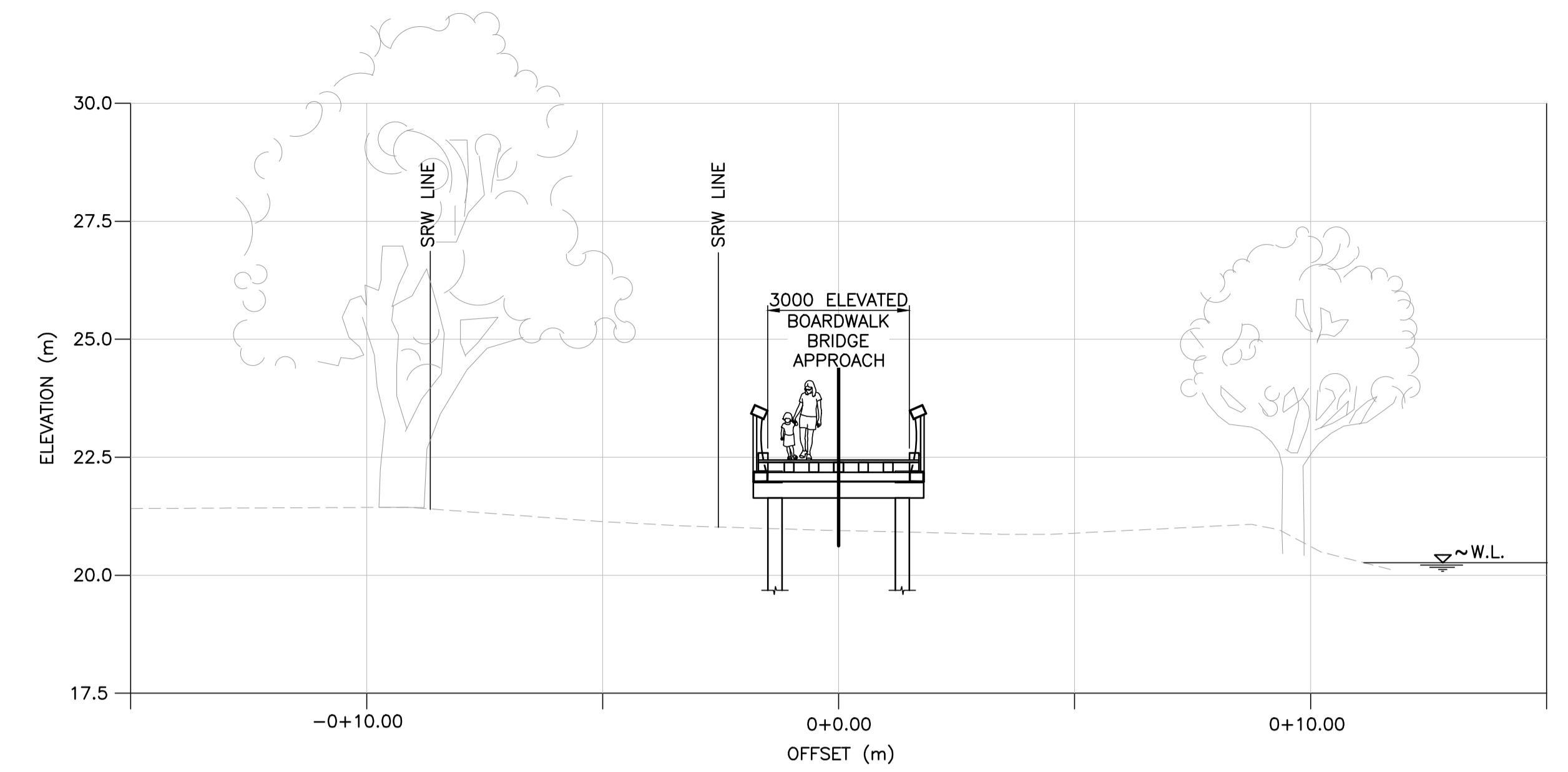

**TYPICAL SECTION - ELEVATED BOARDWALK**  
SCALE 1:100

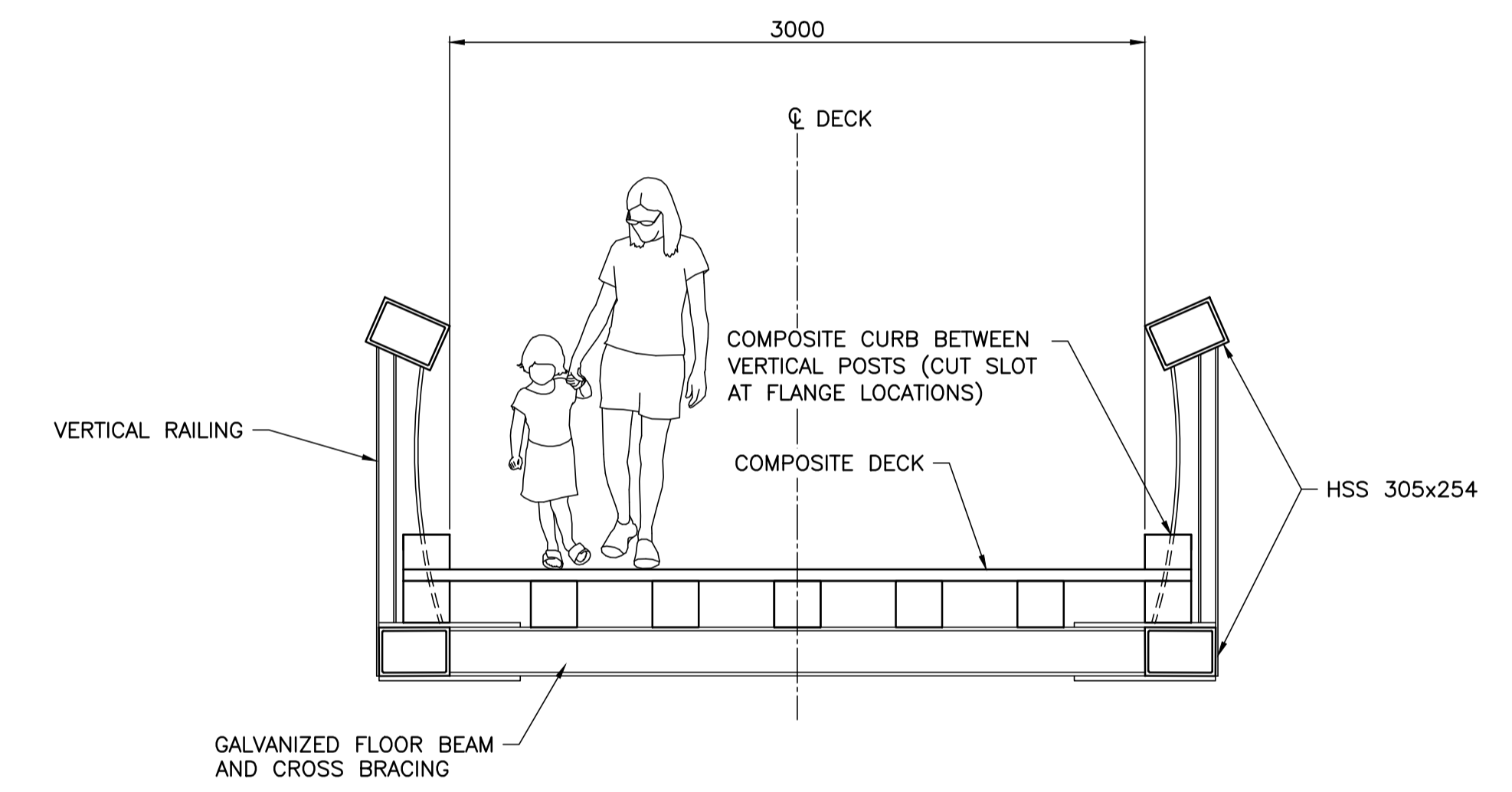

**TYPICAL SECTION - BRIDGE**  
SCALE 1:25

PLOT DATE: February 9, 2024

REV NO	REVISIONS	DATE	DRAWN	APPRD
0	FOR INFORMATION ONLY	2024-02-09	JK	SK



**DEER LAKE BROOK PEDESTRIAN BRIDGE  
BOARDWALK PROFILE AND TYPICAL SECTIONS**



SCALE		DESIGN NO.		DWG. NO.
AS SHOWN	DATE	2024-01-11		02 of 02
DRAWN BY	JK	DESIGN BY	SK	
CHECKED BY	SK	APPROVED BY	SAL	REV. 0