

CITY OF BURNABY

BYLAW NO. 14566

A BYLAW to amend Bylaw No. 4742, being
Burnaby Zoning Bylaw 1965

WHEREAS application for rezoning has been made to the Council;

AND WHEREAS the Council has held a public hearing thereon after duly giving notice of the time and place of such hearing as prescribed by Sections 466 and 467 of the *Local Government Act*, R.S.B.C. 2015, c.1;

NOW THEREFORE the Council of the City of Burnaby ENACTS as follows:

1. This Bylaw may be cited as **BURNABY ZONING BYLAW 1965, AMENDMENT BYLAW NO. 10, 2023.**
2. The Map (hereinafter called “Map ‘A’”), attached to and forming an integral part of Bylaw No. 4742, being “Burnaby Zoning Bylaw 1965”, and designated as the Official Zoning Map of the City of Burnaby, is hereby amended according to the Map (hereinafter called “Map ‘B’”), marginally numbered REZ. 4437 annexed to this Bylaw, and in accordance with the explanatory legend, notations, references and boundaries designated, described, delimited and specified in particularity shown upon said Map ‘B’; and the various boundaries and districts shown upon said Map ‘B’ respectively are an amendment of and in substitution for the respective districts, designated and marked on said Map ‘A’ insofar as the same are changed, modified or varied thereby, and the said Map ‘A’ shall be deemed to be and is hereby declared to be amended accordingly and the said Map ‘B’ is hereby declared to be and shall form an integral part of said Map ‘A’, as if originally incorporated therein and shall be interpreted accordingly.

REZ.20-35

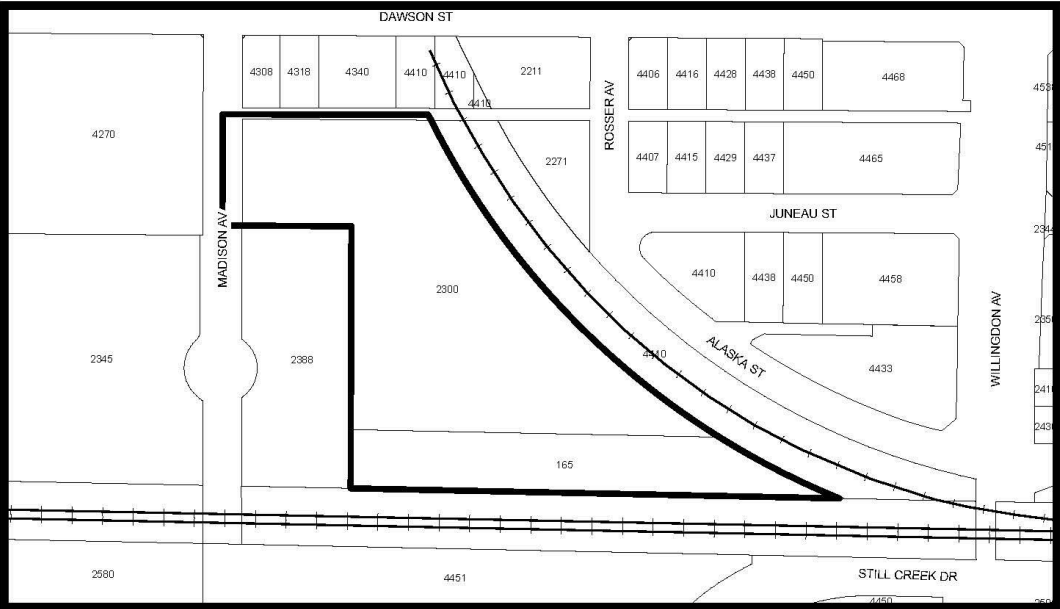

LEGAL: Lot 46, District Lot 119, Group 1, New Westminster District Plan 40447; and Block 13, District Lot 119, Group 1, New Westminster District Plan 2855, Except Plans 40447 and EPP41113



THE AREA(S) SHOWN ABOVE OUTLINED IN BLACK (——) IS (ARE) REZONED

FROM: M1 Manufacturing District and M2 General Industrial District

TO: CD Comprehensive Development District (based on RM4s Multiple Family Residential District, RM4r Multiple Family Residential District and the Brentwood Town Centre Development Plan as guidelines, and in accordance with the development plan entitled "Emerald Place" prepared by Buttjes Architecture Inc.)

		PLANNING AND DEVELOPMENT DEPARTMENT		
Date:	Mar 16 2023	OFFICIAL ZONING MAP		Map "B" No. REZ. 4437
Scale:	1:3,000			
Drawn By:	RW			