

CITY OF BURNABY

BYLAW NO. 14782

A BYLAW to amend Bylaw No. 4742, being Burnaby Zoning Bylaw 1965, as amended by Bylaw No. 14181 being Burnaby Zoning Bylaw 1965, Amendment Bylaw No. 21, 2020

The Council of the City of Burnaby ENACTS as follows:

1. This Bylaw may be cited as **BURNABY ZONING BYLAW 1965, AMENDMENT BYLAW NO. 19, 2025.**

2. Bylaw No. 4742, as amended by Bylaw No. 14181, is further amended as follows:

(a) The Map (hereinafter called “Map ‘A’”), attached to and forming an integral part of Bylaw No. 4742, being “Burnaby Zoning Bylaw 1965”, and designated as the Official Zoning Map of the City of Burnaby, is hereby amended according to the Map (hereinafter called “Map ‘B’”), marginally numbered REZ. 4511, annexed to this Bylaw, and in accordance with the explanatory legend, notations, references and boundaries designated, described, delimited and specified in particularity shown upon said Map ‘B’; and the various boundaries and districts shown upon said Map ‘B’ respectively are an amendment of and in addition to the respective districts, designated and marked on said Map ‘A’ insofar as the same are changed, modified or varied thereby, and the said Map ‘A’ shall be deemed to be and is hereby declared to be amended accordingly and the said Map ‘B’ is hereby declared to be and shall form an integral part of said Map ‘A’, as if originally incorporated therein and shall be interpreted accordingly.

(b) The Comprehensive Development Plan(s), more particularly described in Bylaw No. 14181 is amended as may be necessary by the development plan entitled “Amended Barker + Olive” prepared by IBI Group and on file in the office of the General Manager Planning and Development; and any development on the lands rezoned by this Bylaw shall be in conformity

REZ.25-15

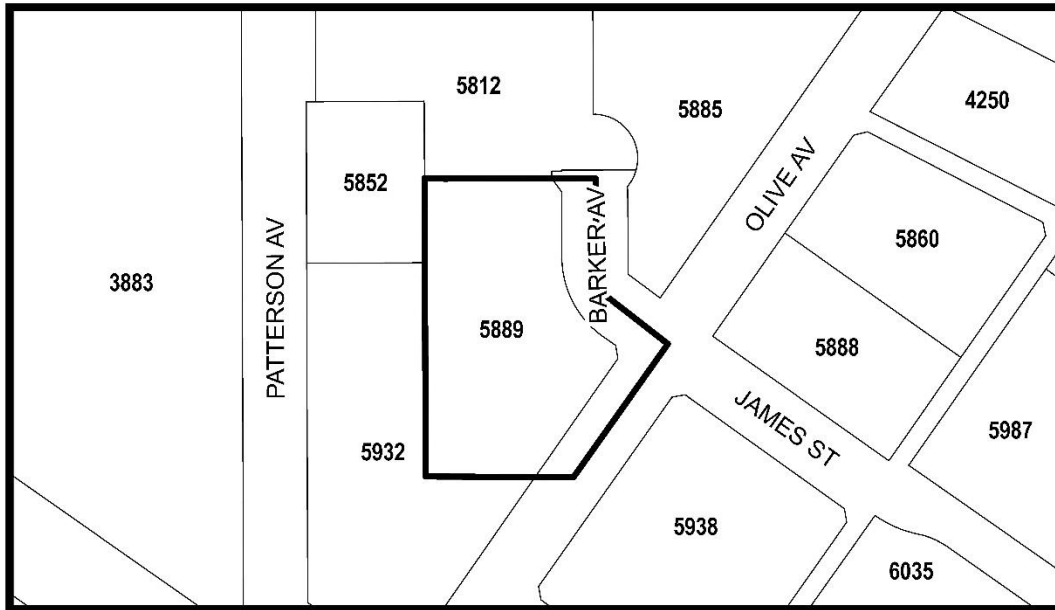

LEGAL: Lot 1 District Lot 151 Group 1 New Westminster District Plan EPP112979



THE AREA(S) SHOWN ABOVE OUTLINED IN BLACK (———) IS (ARE) REZONED

FROM: CD Comprehensive Development District (based on the RM5s Multiple Family Residential District, RM5r Multiple Family Residential District, and Metrotown Downtown Plan as guidelines and in accordance with the development plan entitled "Barker + Olive" prepared by IBI Group)

TO: Amended CD Comprehensive Development District (based on the RM5s Multiple Family Residential District, RM5r Multiple Family Residential District, and Metrotown Downtown Plan as guidelines and in accordance with the development plan entitled "Amended Barker + Olive" prepared by IBI Group)

| | | | |
|-------------------------------------------------------------------------------------|-------------------------------------------------|---------------------------------------------------------------------------------------|--------------------------|
|  | PLANNING AND DEVELOPMENT DEPARTMENT |  | |
| Date: Aug 06 2025 | <h2 style="margin: 0;">OFFICIAL ZONING MAP</h2> | | Map "B" No. REZ. 4511 |
| Scale: 1:1,800 | | | |
| Drawn By: JS | | | |